



COPPER FITTINGS



"WHERE **QUALITY** MEETS **COPPER**"

SINCE 1998

ABOUT US

Established in 1998, MSE is India's **Largest Vintage Copper Fitting Manufacturer**, with a **Manufacturing Unit in Vapi, Gujarat**. We Offer Wide Range of Copper Fittings for **Domestic, Commercial, Industrial & Shipbuilding** Application Under **MSE Brand**

Our **Products** are **Manufactured** using **Top-Quality Material** procured from the **Most Reliable Sources** and are produced deploying the **Latest Technology**. Thus, Our Products are always up to the mark.

When it comes to the **Sphere of Trading**. We take every care to ensure that **Our Product are Packaged in such a way that they reach our clients exactly the way they want to**. We Constantly strive to ensure that we are always able to **live up to the demans of our clients**.

We are full of confidence to stay at the top of **International Refrigeration Component Industry**.

We are approved with **ISO 9001:2015 Certification with RoHS Certification for "Manufacturing & Supply of Copper Fittings."**



MISSION & VISION

**CREATE CUSTOMER VALUE,
BUILD A CENTURY-OLD COMPANY,
BECOME A BENCHMARK IN THE INDUSTRY,**

After around **26 years of development**, the company has grown into a high precision copper fitting manufacturing base that focuses on the production of high-efficiency and environment-friendly copper fittings.

MS Engineerings Company adheres to the enterprise spirit of "**Seeking Change Every Day, Never Being Self-Satisfied, Being Brave to Compete, and Pursuing Excellence**". The company persists in the development of a new type of industrialization, continuously improves the management level, and builds a first-class talent team.

Facing the future, the company will continue to adhere to the business philosophy of operating in accordance with the law, doing business with integrity, independent innovation, and scientific development," market-oriented and customer-centric, insisting on developing enterprises with science and technology, accelerating transformation and upgrading, optimizing product structure, and improving product quality. **Committed to becoming a Leading Enterprise in the Copper Fitting Industry**, MSE people make unremitting efforts to realize our dream to be one of the Global 500 enterprises.

Serving industries across **15+ Countries**, we specialize in exporting precision-engineered copper fittings. Our global footprint reflects our dedication to unmatched **Quality and Service**.

"FROM COPPER ROOTS TO GLOBAL REACH".

ENDFEED

COPPER FITTING



MS ENGINEERING'S End Feed Copper fittings for plumbing and **ACR SYSTEMS** have been at the leading of **INDIA!** Our products can be used in domestic ,commercial and industrial systems. Available I.D.sizes ranging from 1/4" to 3 1/8"

APPLICATIONS OF ENDFEED COPPER FITTING

DOMESTIC APPLICATIONS

- ★ **WATER SUPPLY**
COPPER FITTINGS CONNECT PIPES CARRYING POTABLE WATER FROM THE MAIN LINE TO FIXTURES LIKE SINKS, SHOWERS, AND TOILETS.
- ★ **DRAINAGE**
THEY CONNECT PIPES IN THE DRAINAGE SYSTEM, ENSURING PROPER WASTE DISPOSAL.
- ★ **GAS LINES**
IN SOME CASES, COPPER FITTINGS ARE USED FOR CONNECTING GAS LINES IN HOMES, ALTHOUGH OTHER MATERIALS LIKE PEX MAY BE MORE COMMON.
- ★ **HEATING AND COOLING**
COPPER FITTINGS ARE ALSO USED IN HEATING AND COOLING SYSTEMS, OFTEN FOR CONNECTING RADIATORS AND PIPES.
- ★ **FIRE SPRINKLER SYSTEMS**
COPPER IS A PREFERRED MATERIAL FOR FIRE SPRINKLER SYSTEMS DUE TO ITS RESISTANCE TO HEAT AND FLAMES

COMMERCIAL APPLICATIONS

- ★ **PLUMBING**
COPPER FITTINGS ARE USED IN COMMERCIAL PLUMBING SYSTEMS FOR WATER SUPPLY, DRAINAGE, AND FIRE PROTECTION.
- ★ **HVAC**
COPPER FITTINGS ARE USED IN COMMERCIAL HVAC SYSTEMS FOR HEATING, VENTILATION, AND AIR CONDITIONING.
- ★ **REFRIGERATION**
THEY ARE USED IN COMMERCIAL REFRIGERATION SYSTEMS, ENSURING EFFICIENT COOLING AND DURABILITY.
- ★ **FIRE PROTECTION SYSTEMS**
COPPER FITTINGS ARE USED IN COMMERCIAL FIRE SPRINKLER SYSTEMS, PROVIDING RELIABLE AND DURABLE CONNECTIONS.
- ★ **BUILDING SYSTEMS**
COPPER FITTINGS ARE USED IN COMMERCIAL BUILDINGS, INCLUDING OFFICE BUILDINGS, HOTELS, FACTORIES, & HEALTHCARE FACILITIES.

INDUSTRIAL APPLICATIONS

- ★ **MANUFACTURING**
COPPER FITTINGS ARE USED IN MANUFACTURING PROCESSES, INCLUDING FOOD AND BEVERAGE PROCESSING.
- ★ **CHEMICAL PROCESSING**
COPPER FITTINGS ARE USED IN CHEMICAL PLANTS AND REFINERIES DUE TO THEIR RESISTANCE TO CORROSIVE CHEMICALS
- ★ **OIL AND GAS**
COPPER FITTINGS ARE USED IN OIL AND GAS APPLICATIONS.
- ★ **MEDICAL GAS SYSTEMS**
COPPER FITTINGS ARE USED IN NON-FLAMMABLE MEDICAL GAS SYSTEMS.
- ★ **MARINE APPLICATIONS**
THEY ARE USED IN MARINE HARDWARE, SUCH AS PROPELLER SHAFTS, FITTINGS, AND VALVES.

OTHER APPLICATIONS

- ★ **STORAGE TANKS**
- ★ **GAS POWER PLANTS**
- ★ **HEAT EXCHANGERS**
- ★ **SEAWATER LINES**
- ★ **MILITARY JETS**
- ★ **SHAFTING**
- ★ **CONDENSERS**
- ★ **AUTOMOTIVE**

ADVANTAGES OF ENDFEED

COPPER

FITTING

THERMAL CONDUCTIVITY

Copper has excellent thermal conductivity, making it ideal for applications involving heat transfer.

BACTERIA RESISTANCE

Copper has natural antibacterial properties, which can help to prevent the growth of bacteria in plumbing systems.

SAFE & RELIABLE

First point is material safety, copper is a non-toxic and non-combustible material, which means that copper endfeed fittings do not pose a safety risk to humans or the environment.

HIGH CLEANLINESS

Copper is a non-porous material, which means that it is resistant to the growth of bacteria and other micro-organisms. This makes cheap end feed copper fittings an excellent choice for applications.

DURABILITY

Copper is a strong and durable material, making it suitable for long-term use.

WIDE COMPATIBILITY

Copper fittings are compatible with a wide variety of pipe materials, including copper, steel, and plastic.

EASY TO INSTALL

Copper Endfeed Fittings are designed for quick and easy installation, which helps reduce the risk of installation errors.

RECYCLABILITY

Copper is a highly recyclable material, making it an environmentally friendly choice.



ELBOW 90°

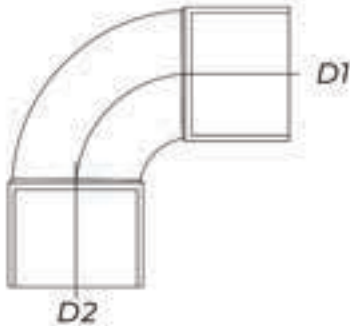

TECHNICAL DRAWING OF
90° ELBOW.

SR.NO	SIZE(INCH)	DIMENSIONS	
		D1	D2
0001	1/4	1/4	1/4
0002	5/16	5/16	5/16
0003	3/8	3/8	3/8
0004	1/2	1/2	1/2
0005	5/8	5/8	5/8
0006	3/4	3/8	3/8
0007	7/8	7/8	7/8
0008	1	1	1
0009	1 1/8	11/8	11/8
0010	1 3/8	13/8	13/8
0011	1 5/8	15/8	15/8
0012	2 1/8	21/8	21/8
0013	2 5/8	25/8	25/8
0014	3 1/8	31/8	31/8



ELBOW 45°



THE TECHNICAL DRAWING OF
COPPER ELBOW 45.



SR.NO

SIZE(INCH)

DIMENSIONS

001

15MM

D1

15MM

D2

15MM

002

5/8

5/8

5/8

003

3/4

3/4

3/4

004

7/8

7/8

7/8

005

1

1

1

006

1 1/8

1 1/8

1 1/8

007

1 3/8

1 3/8

1 3/8

008

1 5/8

1 5/8

1 5/8



U BEND

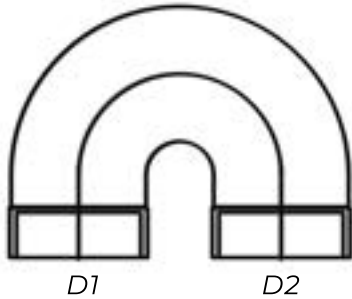

THE TECHNICAL DRAWING OF U-BEND.

SR.NO	SIZE(INCH)	DIMENSIONS	
		D1	D2
001	1/4 (QUARTER INCH)	1/4	1/4
002	5/16	5/16	5/16
003	3/8	3/8	3/8
004	1/2 (HALF INCH)	1/2	1/2
005	5/8	5/8	5/8
006	3/4	3/4	3/4
007	7/8	7/8	7/8
008	1 INCH	1	1
009	1 1/8	1 1/8	1 1/8
010	1 3/8	1 3/8	1 3/8
011	1 5/8	1 5/8	1 5/8
012	2 1/8	2 1/8	2 1/8



EQUAL TEE

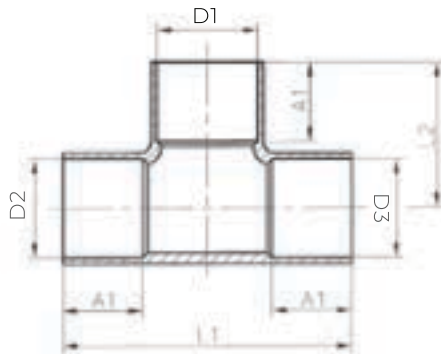

**THE TECHNICAL DRAWING OF
EQUAL TEE.**

SR.NO

SIZE(INCH)

DIMENSIONS

		D1	D2	D3
001	1/4	1/4	1/4	1/4
002	3/8	3/8	3/8	3/8
003	1/2	1/2	1/2	1/2
004	5/8	5/8	5/8	5/8
005	3/4	3/4	3/4	3/4
006	7/8	7/8	7/8	7/8
007	1 1/8	1 1/8	1 1/8	1 1/8
008	1 1/4	1 1/4	1 1/4	1 1/4
009	1 3/8	1 3/8	1 3/8	1 3/8
010	1 5/8	1 5/8	1 5/8	1 5/8

REDUCER

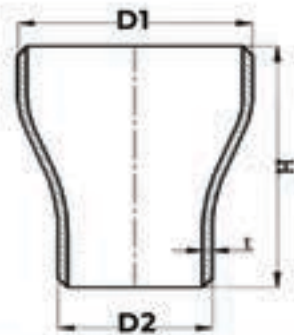

THE TECHNICAL DRAWING OF REDUCER.



SR.NO	SIZE(INCH)	DIMENSIONS	
		D1	D2
0001	5/8 X 1/2	5/8	1/2
0002	3/4 X 1/2	3/4	1/2
0003	3/4 X 5/8	3/4	5/8
0004	7/8 X 5/8	7/8	5/8
0005	7/8 X 3/4	7/8	3/4
0006	1 1/8 X 5/8	1 1/8	5/8
0007	1 1/8 X 7/8	1 1/8	7/8
0008	1 3/8 X 7/8	1 3/8	7/8
0009	1 3/8 X 1 1/8	1 3/8	1 1/8
0010	1 5/8 X 1 1/8	1 5/8	1 1/8
0011	1 5/8 X 1 3/8	1 5/8	1 3/8



LONG RADIUS ELBOW 90°

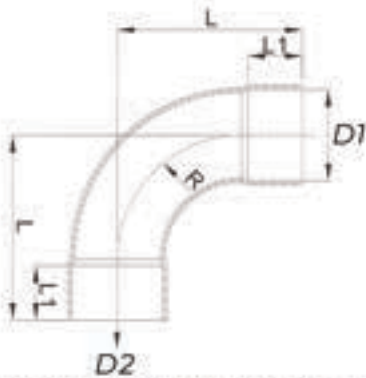

TECHNICAL DRAWING OF LONG RADIUS ELBOW 90°.



SR.NO

SIZE(INCH)

DIMENSIONS

D1

D2

0001	1/4	1/4	1/4
0002	5/16	5/16	5/16
0003	3/8	3/8	3/8
0004	1/2	1/2	1/2
0005	5/8	5/8	5/8
0006	3/4	3/8	3/8
0007	7/8	7/8	7/8
0008	1	1	1
0009	1 1/8	11/8	11/8
0010	1 3/8	13/8	13/8
0011	1 5/8	15/8	15/8
0012	2 1/8	21/8	21/8
0013	2 5/8	25/8	25/8
0014	3 1/8	31/8	31/8



COUPLER

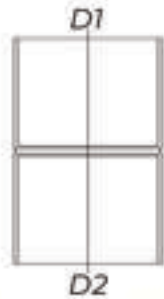

THE TECHNICAL DRAWING OF COUPLER.

SR.NO	SIZE(INCH)	DIMENSIONS	
		D1	D2
0001	1/4 QUARTER INCH	1/4 QUARTER INCH	1/4 QUARTER INCH
0002	5/16	5/16	5/16
0003	3/8	3/8	3/8
0004	12MM	12MM	12MM
0005	1/2 (HALF INCH)	1/2 (HALF INCH)	1/2 (HALF INCH)
0006	15 MM	15 MM	15 MM
0007	5/8	5/8	5/8
0008	3/4	3/4	3/4
0009	22 MM	22 MM	22 MM
0010	7/8	7/8	7/8
0011	1 INCH	1 INCH	1 INCH
0012	28MM	28MM	28MM
0013	1 1/8	1 1/8	1 1/8
0014	1 3/8	1 3/8	1 3/8
0015	1 5/8	1 5/8	1 5/8
0016	1 1/4	1 1/4	1 1/4
0017	1 1/2	1 1/2	1 1/2
0018	1 3/4	1 3/4	1 3/4
0019	2 INCH	2 INCH	2 INCH
0020	2 1/8	2 1/8	2 1/8
0021	2 5/8	2 5/8	2 5/8
0022	3 INCH	3 INCH	3 INCH
0023	3 1/8	3 1/8	3 1/8



COPPER CAPILLARY



SR.NO **CAPILLARY TUBLINGS**

001	0.026"	008	0.060"
002	0.031"	009	0.064"
003	0.036"	010	0.070"
004	0.040"	011	0.075"
005	0.044"	012	0.080"
006	0.050"	013	0.085"
007	0.055"	014	0.090"

STRAINER



**ALL TYPES OF
STRAINER ARE
AVAILABLE**





WEIGHTS IN KILOGRAMS

I.S.W.G. Millimetres Inches	External Diameter IN mm	10	11	12	13	14	15	16	17	18	19	20	21	22	23	24	I.S.W.G. Millimetres Inches
		0.128	0.116	0.104	0.092	0.080	0.072	0.064	0.056	0.048	0.040	0.036	0.036	0.036	0.028	0.024	
3-16	0.098	0.089	0.080	0.070	0.065	3/16
1/4	0.273	0.273	0.262	0.245	0.231	0.214	0.196	0.175	0.151	0.139	0.126	0.112	0.098	0.090	1/4
5/16	0.390	0.390	0.365	0.335	0.312	0.286	0.259	0.229	0.196	0.179	0.162	0.143	0.125	0.115	5/16
3/8	...	0.541	0.507	0.469	0.469	0.425	0.393	0.358	0.322	0.283	0.241	0.220	0.198	0.175	0.152	0.140	3/8
7/16	...	0.713	0.671	0.624	0.572	0.515	0.474	0.430	0.358	0.337	0.286	0.26	0.234	0.206	0.179	0.165	7/16
1/2	12.700	0.857	0.802	0.742	0.676	0.605	0.555	0.501	0.448	0.39	0.331	0.301	0.270	0.238	0.206	0.189	1/2
9/16	14.288	1.001	0.933	0.859	0.779	0.695	0.636	0.574	0.511	0.445	0.376	0.341	0.306	0.269	0.233	0.214	9/16
5/8	15.875	1.145	1.063	0.976	0.883	0.785	0.717	0.646	0.574	0.499	0.421	0.382	0.342	0.301	0.260	0.239	5/8
11/16	+7.462	1.289	1.194	1.093	0.986	0.875	0.798	0.718	0.637	0.553	0.466	0.422	0.378	0.332	0.287	0.264	11/16
3/4	19.050	1.354	1.241	1.210	1.090	0.965	0.879	0.790	0.700	0.607	0.511	0.463	0.414	0.364	0.314	0.288	3/4
13/16	20.638	1.578	1.455	1.327	1.193	1.055	0.960	0.863	0.763	0.661	0.556	0.503	0.450	0.395	0.341	0.313	13/16
7/8	22.225	1.722	1.585	1.444	1.297	1.145	1.041	0.935	0.826	0.715	0.601	0.544	0.486	0.427	0.368	0.338	7/8
15/16	23.812	1.866	1.716	1.561	1.401	1.235	1.122	1.007	0.889	0.769	0.646	0.584	0.522	0.459	0.395	0.363	15/16
1	25.400	2.010	1.846	1.678	1.504	1.325	1.203	1.079	0.952	0.823	0.691	0.625	0.558	0.490	0.422	0.387	1
1-1/8	28.575	2.298	2.107	1.912	1.711	1.505	1.365	1.223	1.078	0.931	0.781	0.706	0.630	0.553	0.476	0.437	1-1/8
1-1/4	31.750	2.586	2.386	2.146	1.918	1.685	1.527	1.367	1.204	1.039	0.871	0.787	0.702	0.616	0.530	0.486	1-1/4
1-3/8	34.925	2.874	2.630	2.380	2.125	1.865	1.689	1.511	1.330	1.147	0.961	0.868	0.774	0.679	0.584	0.536	1-3/8
1-1/2	38.100	3.162	2.891	2.614	2.332	2.045	1.851	1.655	1.456	1.225	1.051	0.949	0.846	0.742	0.638	0.585	1-1/2
1-5/8	41.275	3.450	3.152	2.848	2.539	2.225	2.013	1.799	1.582	1.363	1.142	1.030	0.918	0.805	0.692	0.635	1-5/8
1-3/4	44.450	3.738	3.413	3.082	2.746	2.405	2.175	1.943	1.708	1.471	1.232	1.111	0.990	0.868	0.746	0.684	1-3/4
1-7/8	47.625	4.026	3.674	3.316	2.953	2.586	2.337	2.087	1.834	1.579	1.322	1.192	1.062	0.931	0.800	0.734	1-7/8
2	50.800	4.314	3.935	3.550	3.161	2.766	2.449	2.231	1.960	1.687	1.412	1.273	1.134	0.994	0.854	0.784	2
2-1/8	53.975	4.602	4.196	3.784	3.368	2.946	2.661	2.375	2.086	1.795	1.502	1.354	1.206	1.057	0.908	0.833	2-1/8
2-1/4	57.150	4.890	4.457	4.018	3.575	3.126	2.823	2.519	2.212	1.903	1.592	1.435	1.278	1.120	0.962	0.883	2-1/4
2-3/8	60.325	5.179	4.718	4.252	3.782	3.306	2.986	2.663	2.338	2.011	1.682	1.516	1.350	1.183	1.016	0.932	2-3/8
2-1/2	63.500	5.467	4.979	4.487	3.989	3.488	3.148	2.807	2.464	2.119	1.772	1.597	1.422	1.246	1.070	0.982	2-1/2
...	...	0590	0.485	0.389	0.305	0.230	0.187	0.18	0.113	0.083	0.057	0.047	0.037	0.028	0.021	0.017	...



**MFG. OF COPPER FITTINGS
ESTD. 1998**



**+91 98241 41729
+91 70690 06599**



work.mse1998@gmail.com



www.msengineeringsindia.com



GIDC, VAPI, GUJARAT